

Features

Electrical Properties

Parameter:	Description
Rated Current:	5A
Rated Voltage:	20V DC
Contact Resistance:	100mΩ Max.
Insulation Resistance:	100MΩ Min.
Dielectric Strength:	250V AC 1 min.



Mechanical properties

Parameter:	Description
Operating Temperature:	-25°C~+85°C
Dimensions:	13.0 x 11.0 x 14.8 mm ± 0.1
Operating Force:	0.3 ~ 3Kg
Operating Life:	5000 cycles
Mounting:	SMT
Housing:	PPA , Black
Terminal:	Brass, Tin Plated
Spring:	Bronze, Tin Plated
Pin:	Brass, Tin Plated

Typical applications

- Power input

Description

The SPJ-1050-XX is a Power Jack connector in SMT package.

The connector can be delivered with either 2.0 (SPJ-1050-2.0) or 2.5 mm (SPJ-1050-2.5) center pin.

Electrical

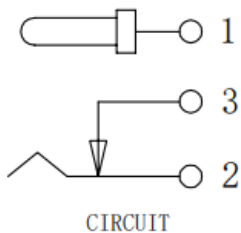

SPJ-1050-XX, Power Jack, 5A / 20V DC, SMT

Dimensions

*unit: mm

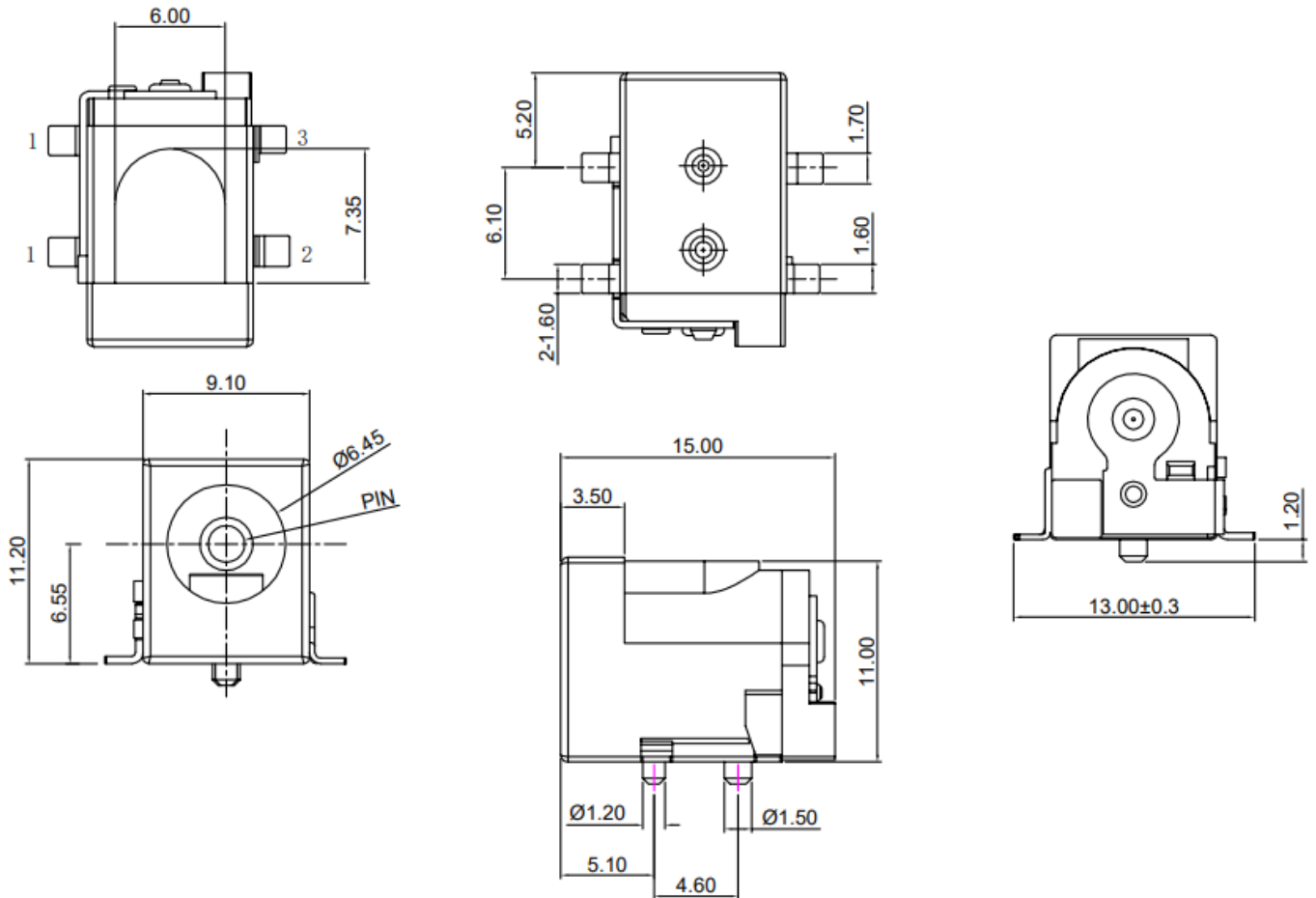

PCB Footprint

*unit: mm

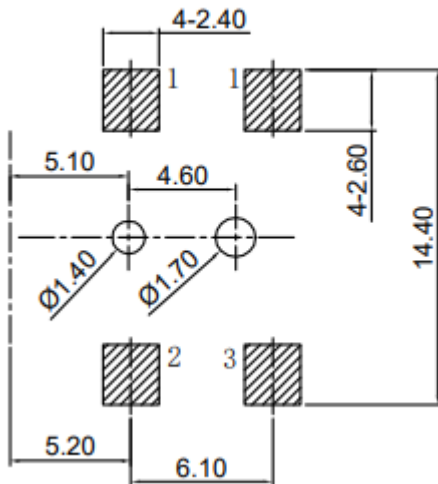

Ordering information

Ordering can be done via www.summit-electronics.com or via info@summit-electronics.com. Please contact us for more information. Customization of the product is available on request.

Technical support

For all product questions please contact us via info@summit-electronics.com